

4

3

2

1

ITEM NO.	PART NUMBER	DESCRIPTION	QTY.
1	CC04430	3" POST CAP	1
2	PO043647	3" X 48" CABLE STAIR END POST	1
3	CR004007	CABLE RAILING ANGLE WASHER FOR HORIZONTAL STAIRS	12
4	BP04450	3" BASE PLATE	1
5	BC015305	3" POST SKIRT	1
6	SS009880	M8 X 80 POST BOLT SS	4
7	CR004009	3" STAIR END POST HOLE PLUG	1

COLOR OPTIONS	
PART NUMBER	COLOR
PC441548B	BLACK
PC441548W	WHITE
PC441548Z	BRONZE

REVISIONS - BALLOONS DENOTE CHANGES			
REV.	DESCRIPTION	DATE	APPROVED
A		03/12/2024	ZAG

B

B

A

A

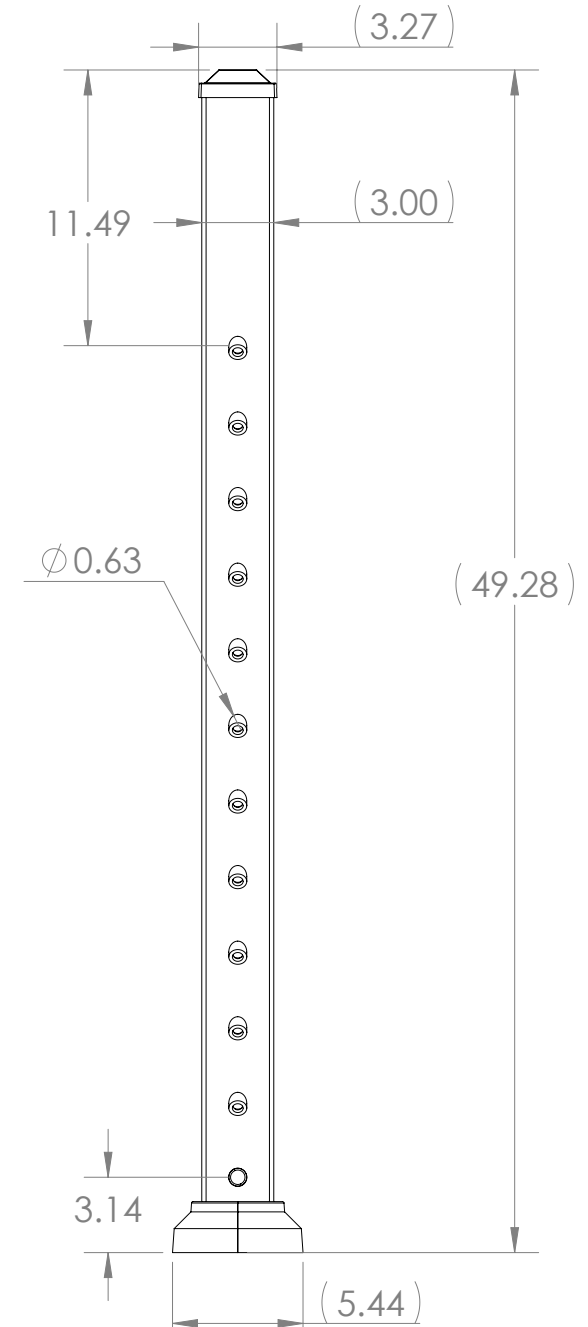
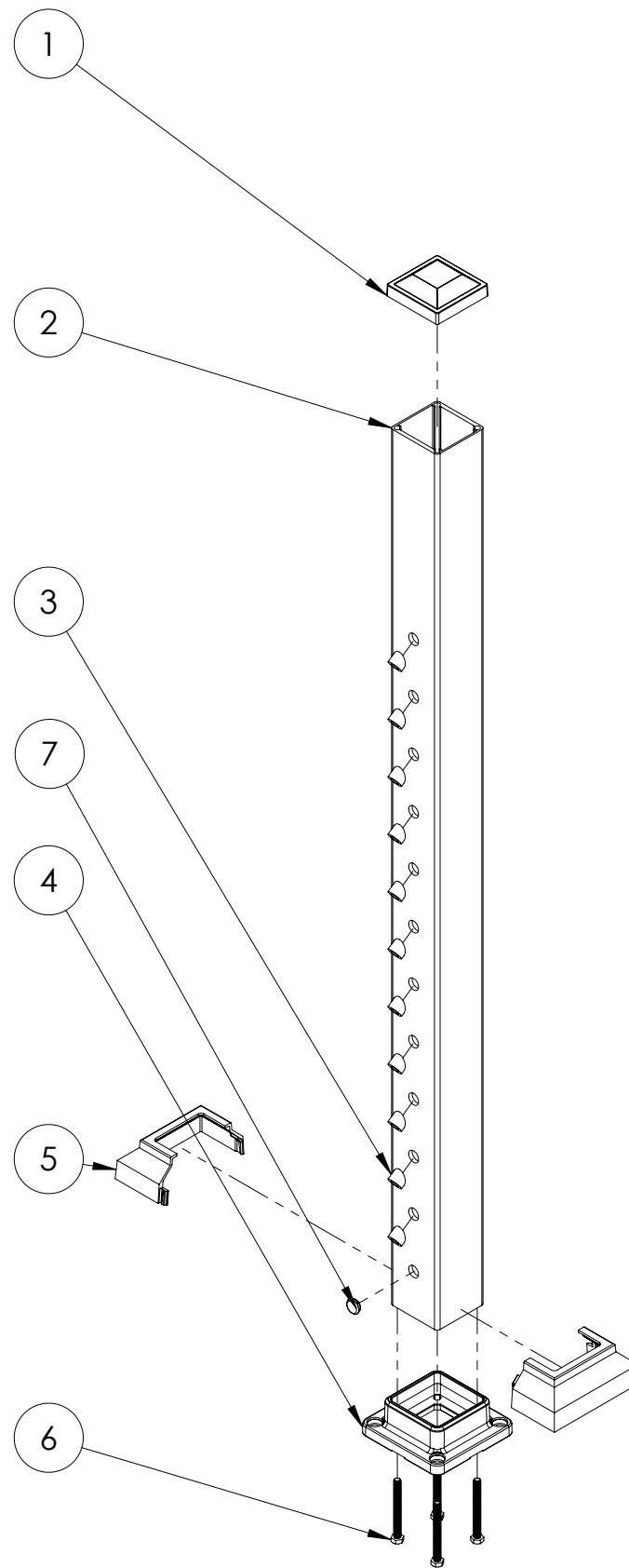
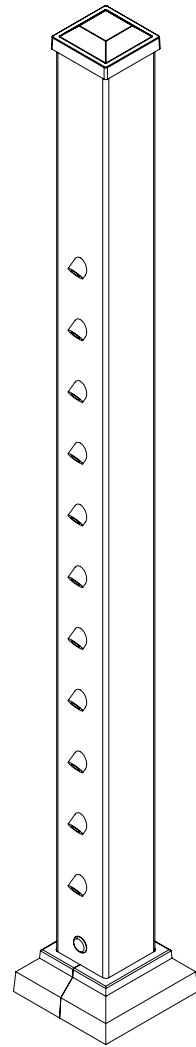

NOTES:
 1. THIS IS FOR A 42" SYSTEM
 2. CR004009 IS ONLY USED FOR FULL FRAME H-CABLE SYSTEMS

UNLESS OTHERWISE SPECIFIED:		NAME	DATE
DIMENSIONS ARE IN INCHES		DRAWN	VINH 03/12/24
TOLERANCES:		CHECKED	
FRACTIONAL ±		ENG APPR.	
ANGULAR: MACH ± BEND ±		MFG APPR.	
TWO PLACE DECIMAL ±			
THREE PLACE DECIMAL ±			
INTERPRET GEOMETRIC TOLERANCING PER:		THIRD ANGLE PROJECTION:	
MATERIAL		PROPRIETARY AND CONFIDENTIAL	
FINISH		THE INFORMATION CONTAINED IN THIS DRAWING IS THE SOLE PROPERTY OF UltraLox. ANY REPRODUCTION IN PART OR AS A WHOLE WITHOUT THE WRITTEN PERMISSION OF UltraLox.	
DO NOT SCALE DRAWING			

TITLE: SHOP DRAWING, WILLIAMS 3" X 48" POST, CABLE STAIR END POST		
SIZE	DWG. NO.	REV
B	PC441548	A
SCALE: 1:12 WEIGHT:		SHEET 1 OF 1

4

3

2

1